



DESKTOP PILOT

THROTTLE BOX SETUP INSTRUCTIONS FOR MICROSOFT FLIGHT SIMULATOR 2020

1. Connect the Type B USB cable to the USB port located at the back of the Throttle Box.



2. Next, plug the other end of the cable into the USB port of your computer or a USB hub.
3. Wait for your computer to detect the Throttle Box device.
4. Configure the device.

Microsoft Flight Simulator 2020

To configure Desktop Pilot's Throttle Box with MSFS2020, follow these steps:

1. Launch Microsoft Flight Simulator.
2. Navigate to Assistance Options and make sure they are set to 'True to Life'

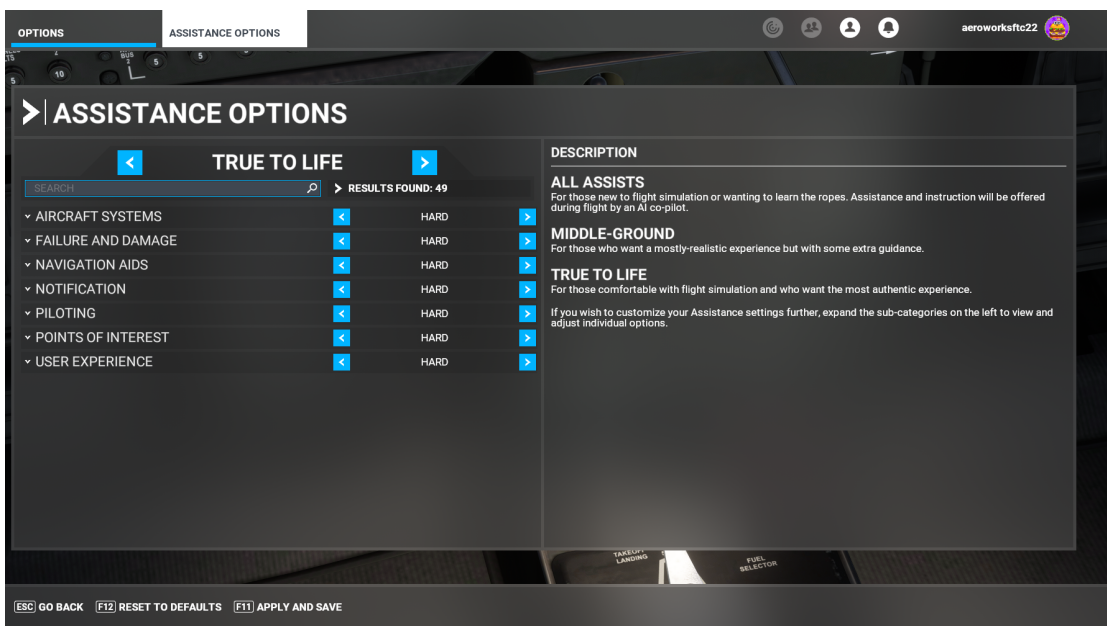



DESKTOP PILOT

3. Navigate to the "CONTROL OPTIONS" menu.

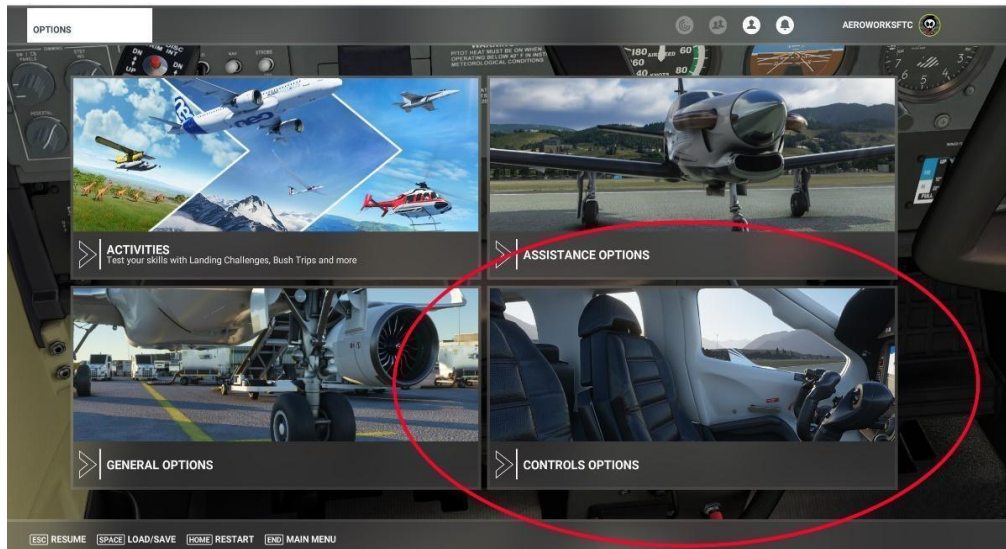

4. Under Control Options, choose your device, which is "THROTTLE BOX".
5. Open the settings menu and select "Power Management". To locate "Power Management", you can either search for it in the "Search by Name" bar or change the "Filter" to "All" and find it in the list.

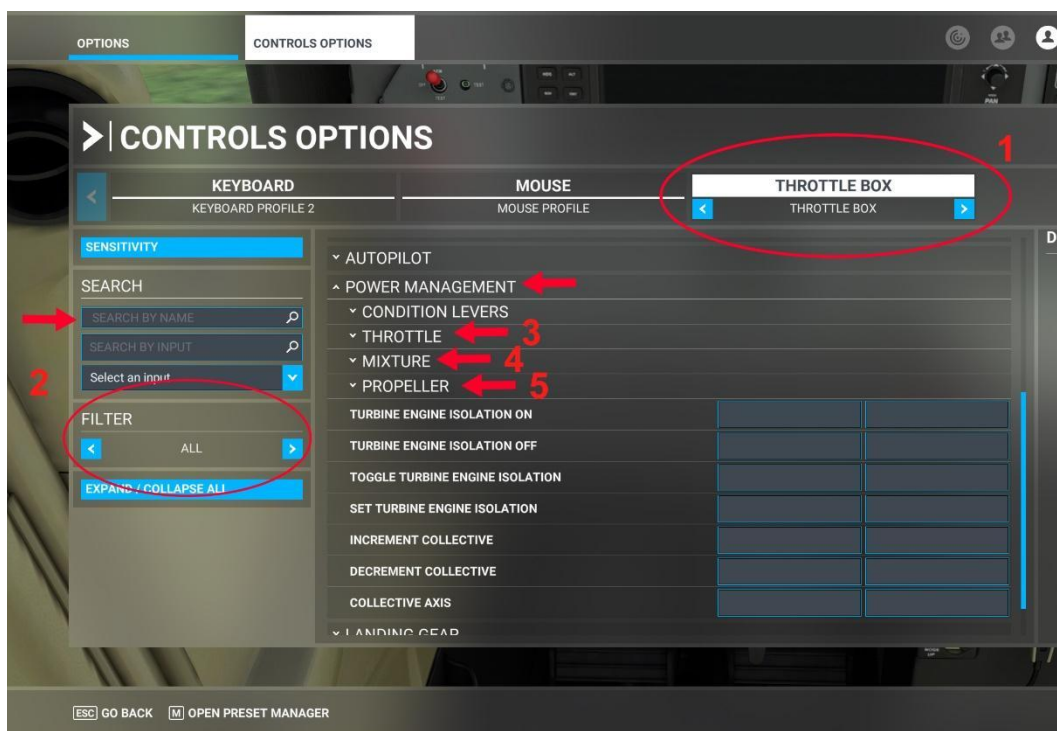

6. Once you're in "Power Management", click on the "Throttle" option. Scroll down and locate "Throttle Axis". To the right of it, select "Joystick L-Axis Z". Make sure to check the 'reverse axis' option to ensure proper functionality.

DESKTOP PILOT

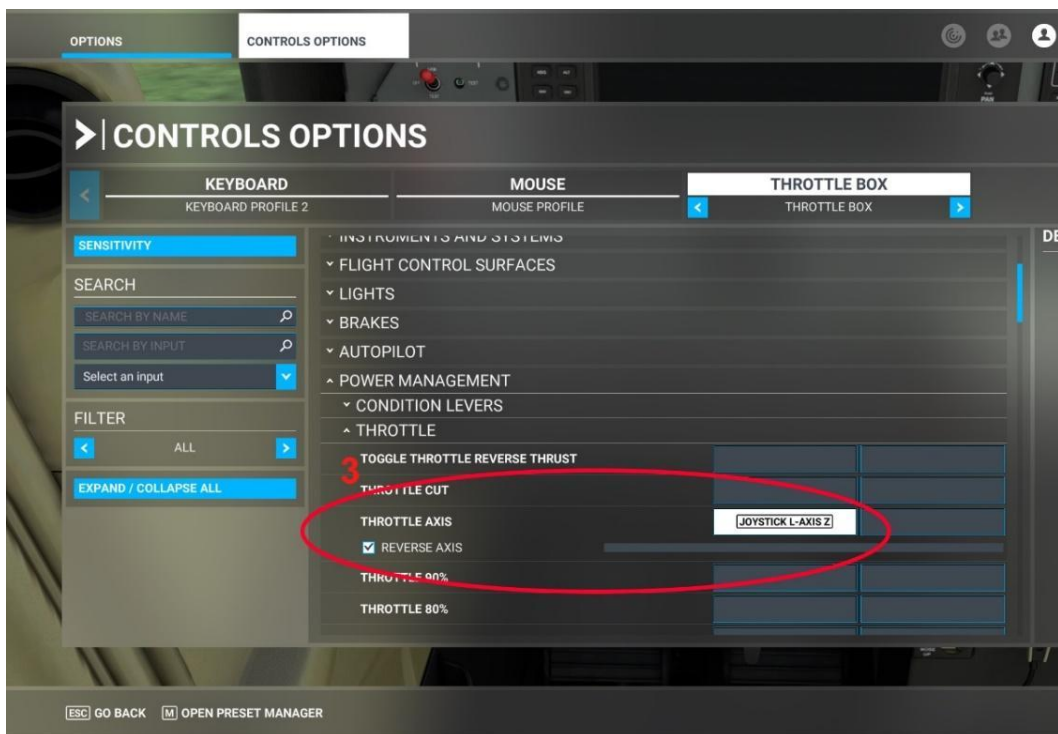

- Next, click on the "Mixture" option. Scroll down and locate "Mixture Axis (-100 to 100%)". To the right of it, select "Joystick L-Axis X". Make sure to check the 'reverse axis' option to ensure proper functionality.

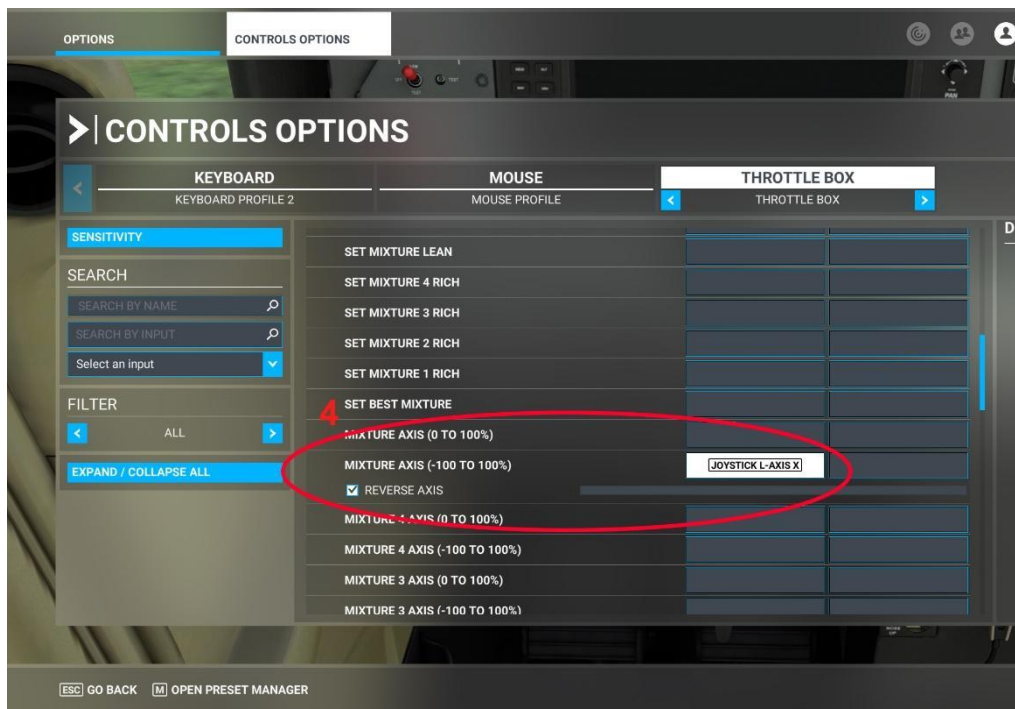

- Finally, click on the "Propeller" option. Scroll down and locate "Propeller Axis". To the right of it, select "Joystick L-Axis Y". Make sure to check the 'reverse axis' option to ensure proper functionality.

DESKTOP PILOT

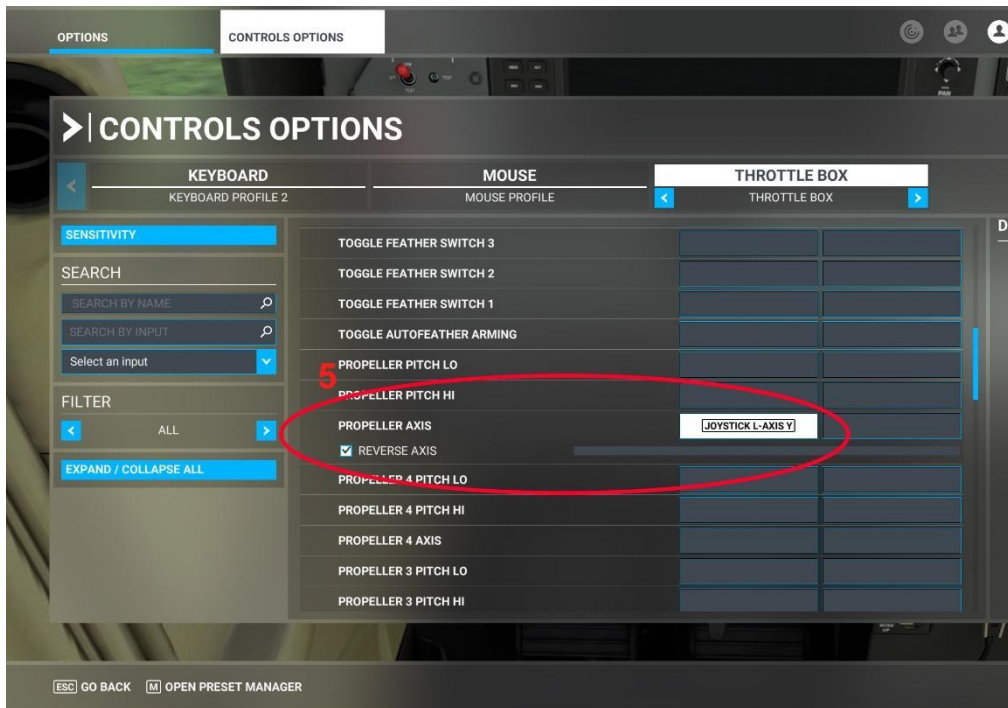

9. Lastly, check to see if the product is working correctly in MSFS by testing the throttle, mixture, and propeller controls.

Congratulations! You have successfully set up the Throttle Box! Happy flying!

In case you encounter any issues during setup, please feel free to contact our customer support team at sales@desktoppilot.com for further assistance.

